

parts-n°	order qty	description
141072	1	SPRING GUIDE M70 HT
160097	1	SPRING RETAINER D 8,2/19
160101	1	SPRING RETAINER D 10,5/19
160112	1	WEAR PLATE M 70
160134	1	FIXING BRACKETS M 70
220032	1	PRESSURE SPRINGS 48,5/D 1
240041	1	O-RING D 15,1/10,3 X 2,4
320014	1	CASING CONTROL UNIT END M
320025	1	CASING CONTROL UNIT CENTR
320036	1	CAS. CONTR. UN. END M70 .
320047	1	CAP 1/2" BSP BLANK
320084	1	1/2' RG CAP
320095	1	1' RG CAP
320482	1	ELBOW 60° BSP1/2" M-F
322069	1	3/4' UNION W.INS.1/2'PIP.THREA
330061	1	O-RING 16.0 X 11.0 X 2.5 PUR
330131	1	CASING CONTROL UNIT MODEL
330142	1	O-RING 69.0 X 65.0 X 2.0 PUR
330153	1	VALVE CONE D 26
330164	1	SPACER CONTROL UNIT MODEL
330197	1	SPRING GUIDE
330201	1	VALVE CONE D24

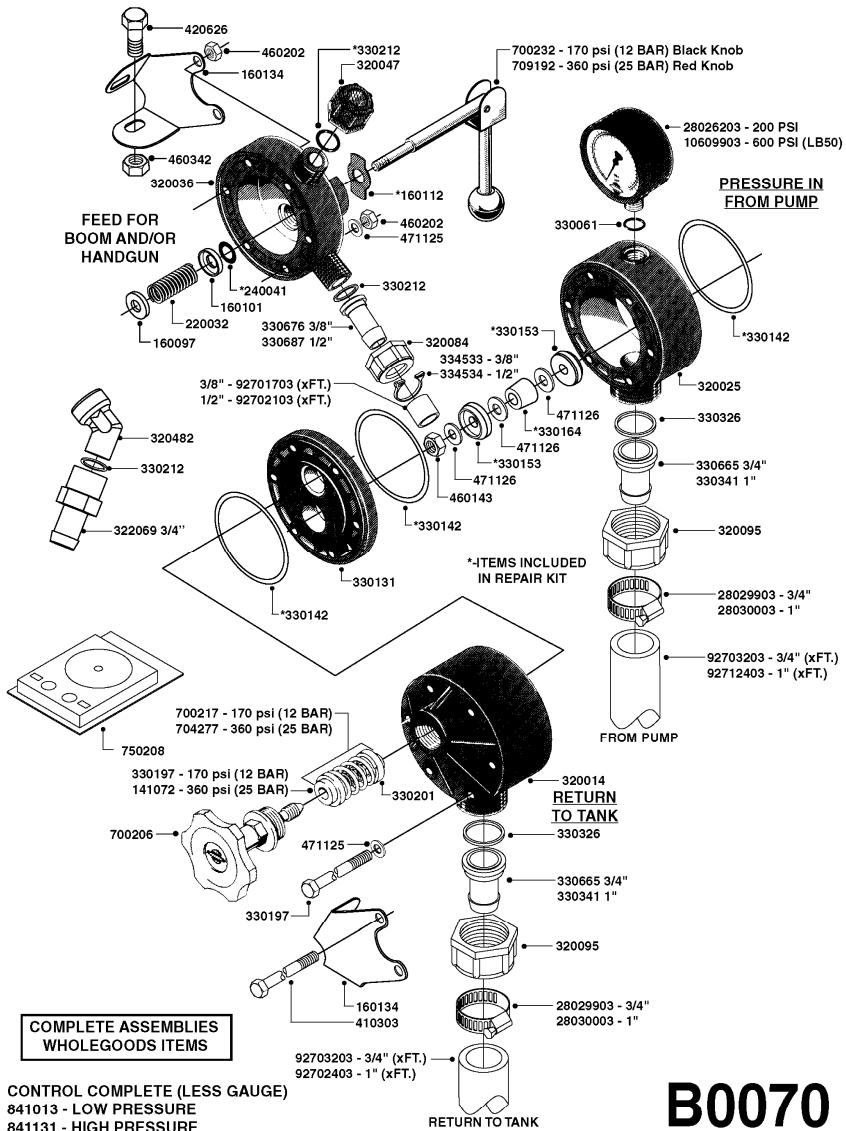

B0070

parts-n°	order qty	description
330212	1	O-RING 19.0 X 14.0 X 2.4 PUR
330326	1	O-RING 30.0 X 24.0 X 2.0 PUR
330341	1	TAIL - 1' FOR 1' RG CAP
330665	1	3/4' HOSE TAIL F/1' CAP
330676	1	3/8" TAIL FOR 1/2" CAP
330687	1	1/2' HOSE TAIL F1/2' CAP
334533	1	CLAMP HOSE PLASTIC 3/8"
334534	1	CLAMP 1/2" HOSE
410303	1	BOLT M6 X 130 MAGND
420626	1	SCREW M10 X 20 DIN 933 S/LESS
460143	1	NUT, NYLOC M8 A2
460202	1	NUT M6 G304 SS PLAIN
460342	1	NUT M10 PLAIN G304 SS
471125	1	WASHER M6U 6.4X14X1.2,A2 SS
471126	1	WASHER M8 16X8.4X1.6 SS G304
700206	1	RELIEF SCREW CPL 3/4' RG
700217	1	PRESSURE REGULAT SPRING (A
700232	1	PISTON ROD W/HANDLE
704277	1	PRESSURE SPRING CPL M 70
709192	1	HANDLE CONTROL UNIT RED M
750208	1	OVERHAUL KIT M-70
841013	1	OPERATING UNIT M70

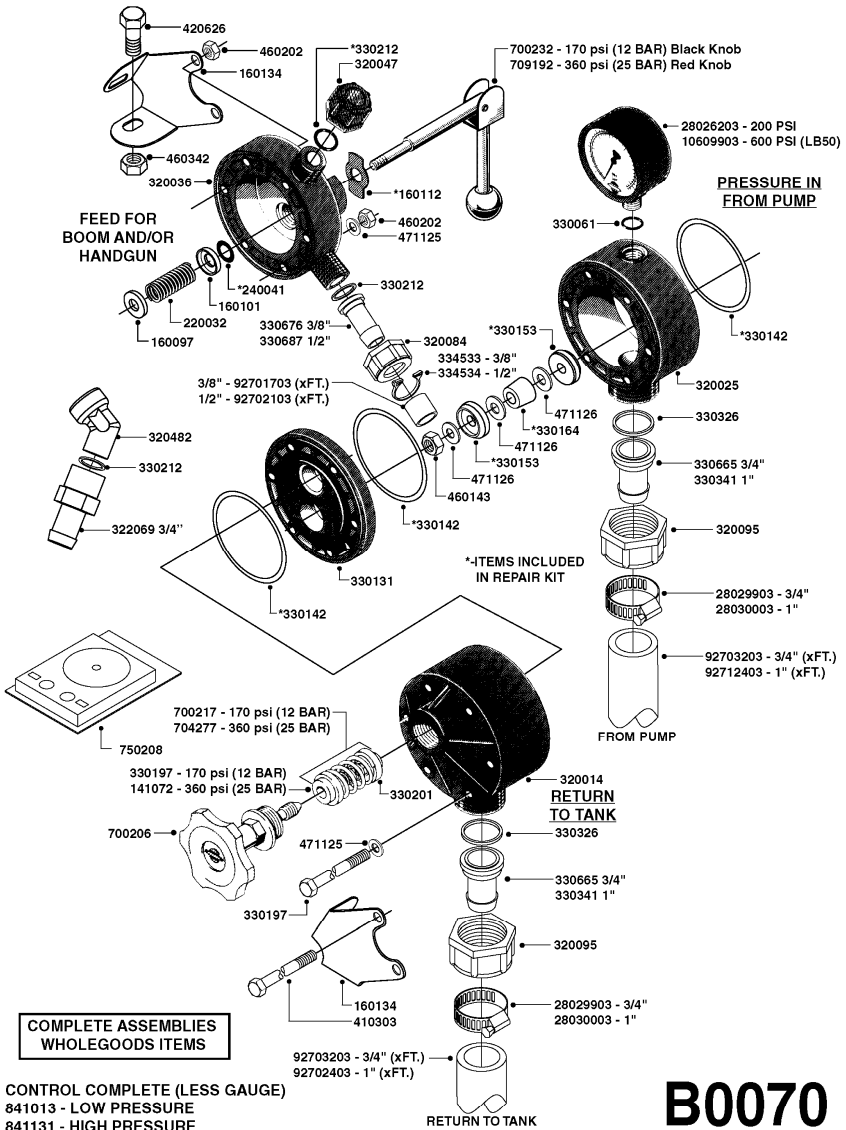

parts-n°	order qty	description
841131	1	CONTROL UNIT - M70 HIGH PRESSURE
10609903	1	GAUGE 2.5" SS BOTT. PSI 600
28026203	1	GAUGE 200PSI/BR, 2.5"1/4BSP-BTM
28029903	1	CLAMP HOSE GEAR P3/4"-S1" 6712
28030003	1	CLAMP HOSE GEAR P1" 6716
92701703	1	HOSE R X3/8" X300PSI WP X0012"
92702103	1	HOSE R X1/2" X300PSI WP X0012"
92702403	1	HOSE PVC SUCT GRAY 1"
92703203	1	HOSE R X3/4" X300PSI WP X0012"
92712403	1	HOSE R X1" X300PSI WP X0012"